

2018

LIMITED, AQMD ASBESTOS SURVEY

For Riverside County Parks

Yun Baird, Planner

Structure located at: Jensen Alvarado Ranch House
4307 Briggs Street
Riverside, CA 92509

Reference # AS2018-008, Window renovation



Heidi Barrios, MBA, REHS, CAC
Inland Empire Asbestos Consulting
May 18, 2018



Table of Contents

Title Page	3
Summary:	4
AQMD ASBESTOS SURVEY	5
1.0 Purpose of Survey:	5
2.0 Sampling Methodology:	6
2.1 Quantity of Samples:.....	6
2.2 Gathering Suspected Asbestos-Containing Material:	6
3.0 Analysis:	6
4.0 Findings:	7
5.0 Discussion Concerning Inaccessible Areas:	7
6.0 Building Materials Not Containing Asbestos	7
7.0 Conclusion:	7
8.0 Recommendations:	7
Diagram 1 - Asbestos Sampling Points:	8
Asbestos Laboratory Results	9

Title Page

Reference Number: AS2018-008, Window Renovation

Date of Report: May 28, 2018

Date of Field Evaluation: May 18, 2018

Individual Requesting Evaluation: Yun Baird
Riverside County Parks
4600 Crestmore Road
Jurupa Valley, CA 92509

Survey Site: Jensen Alvarado Ranch House
4307 Briggs Street
Riverside, CA 92509

Principal Investigator / Author: Heidi Barrios, MBA, REHS, IH
Certified Asbestos Consultant
CAC, DOSH #17-5974
Inland Empire Asbestos Consulting
18385 Mariposa Avenue
Riverside, CA 92508
951-675-4062

Summary:

The purpose of this assessment is to determine the amount of asbestos on the windows of four structures at the Jensen Alvarado Ranch.

A total of 6 bulk building material samples were taken for analysis which resulted in a total of 6 analyses. None of the samples analyzed were found to contain one percent or greater asbestos. The result of the laboratory analysis can be found in Table 1 and in the appendix. Sampling locations are illustrated in diagram

Heidi Barrios, a Certified Asbestos Consultant, (#17-5974) and a State of California, Division of Occupational Safety and Health (DOSH) Certified Building Inspector, (CA-015-05) conducted the inspection on April 6, 2018.

See "CONCLUSION" for required actions by the owner and/or responsible party.

AQMD ASBESTOS SURVEY

1.0 Purpose of Survey:

The Clean Air Act required the USEPA to develop and enforce regulations to protect the general public from exposure to airborne contaminants known to be hazardous to human health. The EPA established the National Emission Standards for Hazardous Air Pollutants (NESHAP) under the authority of Section 112 of the Clean Air Act.

The Asbestos NESHAP requires that a thorough asbestos survey be conducted prior to commencement of any renovation or demolition, and specifies that building materials containing greater than 1% asbestos are considered asbestos-containing material (ACM) and is considered asbestos waste. In addition, the provisions of the California Labor Code, Section 6501.8 (b) and Title 8, CCR 341.6 specify that asbestos-containing construction material (ACCM) is identified as any manufactured construction material greater than 0.1 % asbestos. This standard is for occupational exposure.

Evaluation of the possible sources of ACM in the accessible areas of the above mentioned structures must be completed in accordance with South Coast Air Quality Management District (AQMD) rule 1403 prior to renovation or demolition of building structures.

2.0 Sampling Methodology:

2.1 Quantity of Samples:

The survey was conducted in accordance with guidelines established by the U.S. EPA in its 1985 publication, *Guidance For Controlling Asbestos Containing Materials in Buildings*, Office of Pesticides and Toxic Substance, EPA 560/5-85-024, and the requirements the Asbestos NESHAP and the local AQMD. Certain aspects of the U.S. EPA's Asbestos Hazard Emergency Response Act (AHERA) bulk sampling protocol were used in the visual inspection to physically assess each sample and to categorize sampled materials.

For friable materials the provisions of 40 CFR 763.107 are followed (minimum of 3 samples for suspected friable building materials).

For non-friable materials [tile, roofing products, vinyl floor coverings, transite sheeting and pipes (may be assumed to be asbestos containing building material (ACBM)), sheet rock, stucco, etc.] sufficient number of samples based on industrial hygienist experience and judgment shall be taken to determine presence of asbestos. Frequently, one sample may be sufficient for each building material type.

2.2 Gathering Suspected Asbestos-Containing Material:

Each suspect ACBM identified was sampled in accordance with sampling guidelines established by USEPA.

First, the suspected material is wetted with water to minimize possible fiber release. Tools are then used to free the suspect material from its substrate. The material is then placed in its own sample bag and labeled with a unique number ("Client's Sample Number"). The samples are then transported to the lab for analysis.

3.0 Analysis:

Asbestos bulk analysis using dispersion staining and polarized light microscopy (PLM) was used. The methodology used is EPA 600/ R-93/116. QuanTEM Laboratories at 2033 Heritage Drive, Oklahoma City, OK is a National Voluntary Laboratory Accreditation Program (NVLAP) accredited laboratory (Lab code 101959). Phone # (405) 755-7272.

4.0 Findings:

Diagram 1 illustrates an overview of property and bulk building sampling locations taken from the structure.

5.0 Discussion Concerning Inaccessible Areas:

An inspection was made of all accessible areas on the site. Based on the material present at the site it is unlikely that additional asbestos containing material may be found.

An area is considered accessible if it can be fully explored. If the inspector feels it is unsafe to enter an area, or if size considerations restrict entry, the area is considered inaccessible. Speculations on whether an area might contain asbestos are based on the inspector's knowledge and experience.

6.0 Building Materials Not Containing Asbestos

The following suspect materials were tested and no asbestos was detected:
Grey window putty.

7.0 Conclusion:

Asbestos containing building materials were **not** present, on the windows of the sites surveyed.

8.0 Recommendations:

South Coast AQMD Rule 1403 does **not** require notification for *renovations* with no asbestos, or asbestos content less than or equal to 1%. Other Rule 1403 requirements such as emissions controls and recordkeeping apply.

Diagram 1 - Asbestos Sampling Points: 4307 Briggs Street Riverside, CA

An "X" illustrates the locations of samples taken, + indicates positive ACM sample and - indicates a negative ACM sample. The client's sample number (for reference to the lab report in the appendix) may be obtained by attaching the prefix "JA - " to each location number.

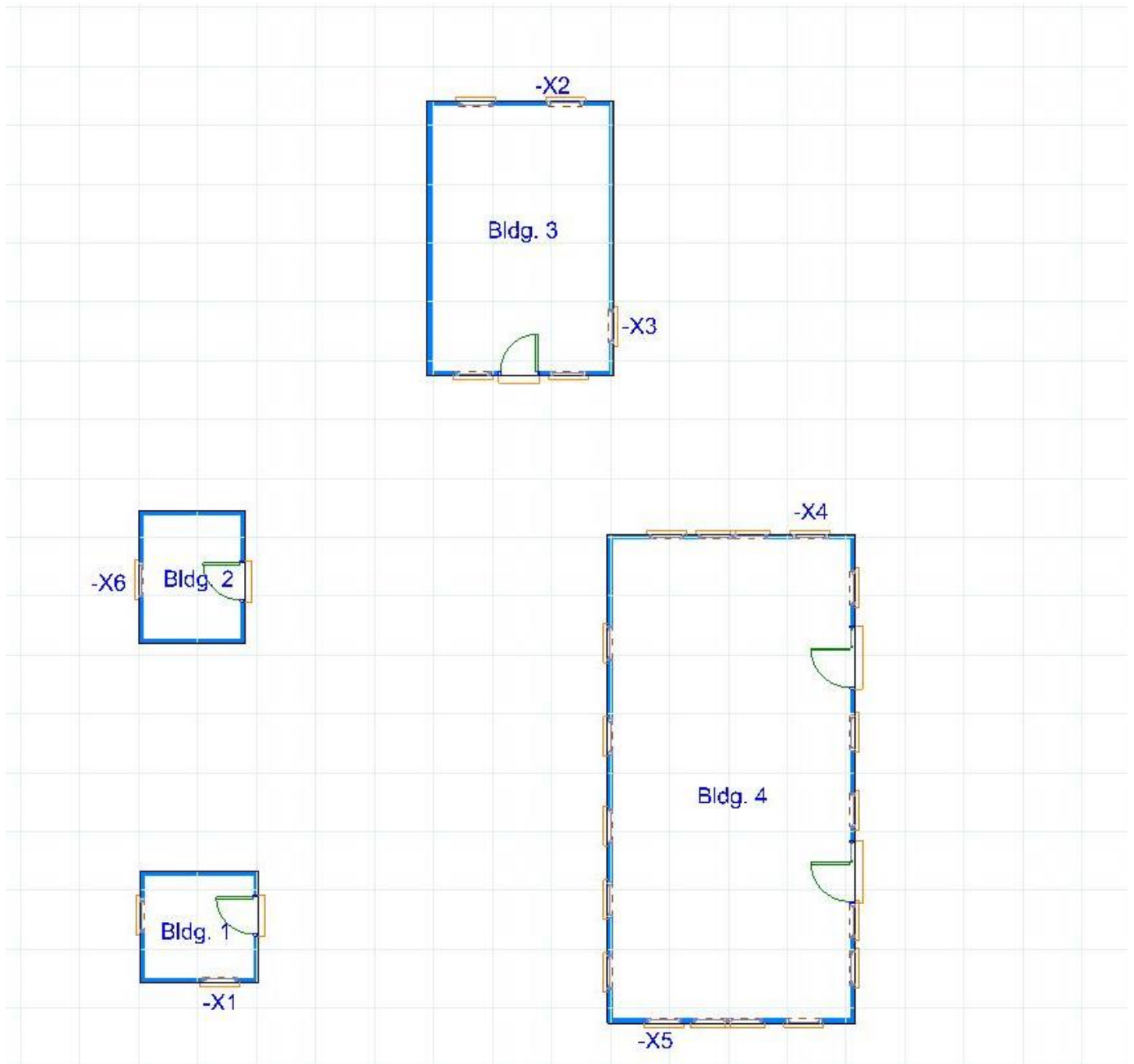

Asbestos Laboratory Results



2033 HERITAGE PARK DR, OKLAHOMA CITY, OK 73120 | 1.800.822.1650

Polarized Light Microscopy Asbestos Analysis Report

Quantem Lab No. 294676
 Account Number: C164
 Date Received: 05/23/2018
 Received By: Katie Davis
 Date Analyzed: 05/24/2018
 Analyzed By: Cassie Sanborn
 Methodology: EPA/600/R-93/116

Client: Inland Empire Asbestos Consulting
 18385 Mariposa Ave
 Riverside, CA 92508

Project: Parks-Jensen Alavardo
 Project Location: 4307 Briggs St. Riverside
 Project Number: AS2018-008

Quantem Sample ID	Client Sample ID	Composition	Color / Description	Asbestos (%)	Non-Asbestos Fiber (%)	Non Fibrous
001	JA-1	Homogeneous	Gray Putty	Asbestos Not Present	NA	CaCO3
002	JA-2	Homogeneous	Gray Putty	Asbestos Not Present	NA	CaCO3
003	JA-3	Homogeneous	Gray Putty	Asbestos Not Present	NA	CaCO3
004	JA-4	Homogeneous	Gray Putty	Asbestos Not Present	NA	CaCO3
005	JA-5	Homogeneous	Gray Putty	Asbestos Not Present	NA	CaCO3
006	JA-6	Homogeneous	Gray Putty	Asbestos Not Present	NA	CaCO3

Cassie Sanborn

Cassie Sanborn, Analyst

5/24/2018

Date of Report

Unless otherwise noted, upon receipt the condition of the sample was acceptable for analysis.

Quantem is a NVLAP accredited PLM laboratory (Lab Code: 101959-0). This report relates only to the specific items tested. NVLAP accreditation applies only to analysis performed utilizing EPA/600/M4-82-020 and EPA/600/R-93/116 methods. This report may not be used to claim product endorsement by NVLAP or any agency of the US Government. This report may not be reproduced except in full, without the written approval of the laboratory.



ASBESTOS CHAIN OF CUSTODY

2033 Heritage Park Drive, Oklahoma City, OK 73120-7502
 (800) 822-1650 • (405) 755-7272 • Fax: (405) 755-2058

LEGAL DOCUMENT - PLEASE PRINT LEGIBLY

For Lab Use Only
 Lab No. 244079
 Accept Reject
 Report Results (one box)
 QuantEM Website
 Email
 Other

Contact Information		Project Information	
Company: <u>Inland Empire Asbestos Consulting</u>	Phone: <u>951-675-4062</u>	Project Name: <u>Parts - Jensen Alvarado</u>	
Contact: <u>Heidi Barrios</u>	Cell Phone: <u>714-267-8000</u>	Project Location: <u>4207 Briggs St. Riverside</u>	
Account #: <u>C164</u>	Email: <u>heidi@inlandempire.com</u>	PO Number: <u>AS2018-008</u>	
SAMPLED BY: Name: <u>Heidi Barrios</u>	Date:		

RELINQUISHED BY	VIA	RECEIVED BY	DATE & TIME
<u>Heidi Barrios</u>	<u>Fed Ex</u>	<u>[Signature]</u>	<u>5-21-18 8:00am</u>
			<u>5/23/18 10:35</u>

REQUESTED SERVICES (Please the Appropriate Boxes)

PLM	PLM	TEM	TEM	TURNAROUND TIME
<input checked="" type="checkbox"/> Bulk Analysis (EPA 600/R-93/116)	<input type="checkbox"/> Vermiculite Attic Insulation (EPA 600/R-04/004)	<input type="checkbox"/> Air-AHERA	<input type="checkbox"/> Bulk-Presence / Absence EPA600/R-93/116	<input type="checkbox"/> Rush
<input type="checkbox"/> 400 Point Count	<input type="checkbox"/> Other	<input type="checkbox"/> Air-NIOSH 7402	<input type="checkbox"/> Bulk-Quantitative (weight%) - Charfield	<input type="checkbox"/> Same Day
<input type="checkbox"/> 1000 Point Count		<input type="checkbox"/> Air-ISO 10312	<input type="checkbox"/> Dust-Presence / Absence	<input checked="" type="checkbox"/> 24 - Hour
<input type="checkbox"/> Gravimetric Preparation	PCM	<input type="checkbox"/> Drinking Water- EPA 100.2	<input type="checkbox"/> Dust-Quantitative (fibers/sg.cm) - ASTM D5755	<input type="checkbox"/> 3 - Day
<input type="checkbox"/> Particle ID	NIOSH 7400	<input type="checkbox"/> Waste Water- EPA 600/4-83-043	Other	<input type="checkbox"/> 5 - Day

No.	Sample ID (10 Characters Max)	To Be Analyzed	Color	Description	Volume / Area (as applicable)	Comments / Notes
1	JA-1	<input checked="" type="checkbox"/>	Gray	Putty	Window	Bldg 1
2	JA-2	<input checked="" type="checkbox"/>	Gray	Putty	Window	Bldg 3
3	JA-3	<input checked="" type="checkbox"/>	Gray	Putty	Window	Bldg 3
4	JA-4	<input checked="" type="checkbox"/>	Gray	Putty	Window	Bldg 4
5	JA-5	<input checked="" type="checkbox"/>	Gray	Putty	Window	Bldg 4
6	JA-6	<input checked="" type="checkbox"/>	Gray	Putty	Window	Bldg 2
7		<input type="checkbox"/>				
8		<input type="checkbox"/>				
9		<input type="checkbox"/>				
10		<input type="checkbox"/>				

SATURDAY FEDEX SAMPLE DELIVERY - CALL TO SCHEDULE • Use this address for Saturday Delivery only: 4220 N. Santa Fe Ave., Oklahoma City, OK 73105-6517 • Mark Package "Hold for Saturday Pickup"
 Please Note - UPS and USPS are NOT available for Saturday Delivery